



LTE Modem Huawei B2368 – 66 – The signal indicator is not lit



- If this indicator is off, the contact between the outdoor and indoor units is interrupted.
- We check the correct connection of the cable to the PoE port.
- If it is pushed in correctly and holds, we disconnect it and check if there is no object in the socket that could break the contact and insert the cable back.
- We will restart by turning off - 10 sec. wait and turn on the modem.
- If the repair failed, reset the router by pressing the reset button for at least 15 seconds.



Notice:

All Wi-Fi settings are reset to factory settings as well, you need to find the Wi-Fi name and password on the modem label.

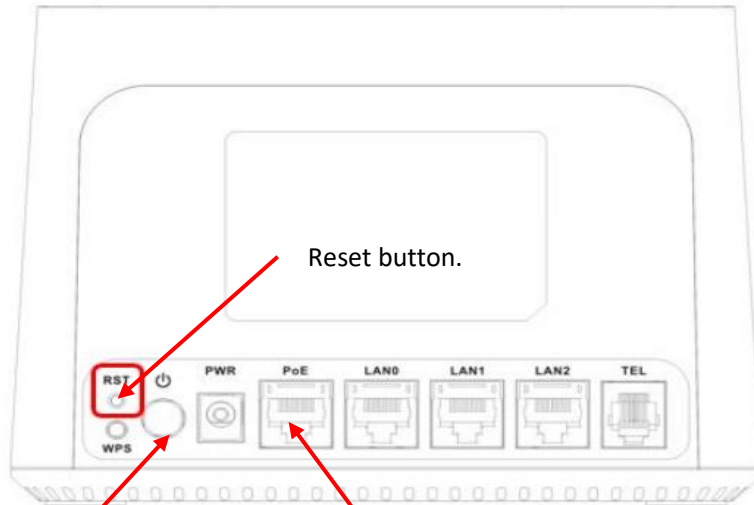

On/Off button.

PoE port for the cable.

The troubleshooting procedure did not help?



- If even a reset does not help to solve the problem, you need to contact the technical support department by calling us or using the Tobi chatbot on our website www.vodafone.cz.
- **Only a service technician authorized by Vodafone can replace the router or antenna (manipulate it).**